



WELCOME! KURUME

Olympic & Paralympic Pregame Training Camp Guide





NEXT STAGE

Athlete's City Kurume

Faster, Higher, Stronger! Kurume City provides its full support to athletes pushing the boundaries of the human body and making the impossible happen. Having served as a host to major competitions for a variety of competitive sports, the Kurume Sports Complex Gymnasium is being completely remodeled and will open in spring 2018. The nature and beauty of Chikugo River, which is Kyushu's largest, complements these facilities that will be the ideal training camp venue for Tokyo Olympians and Paralympians to maximize their performance.

〈 Information About Kurume City 〉

- Area: 229.96km² (as of November 2016)
- Population: 306,835 (as of November 2016)
- Households: 131,794 (as of November 2016)
- Climate: The changes in each of the four seasons are wonderful. With little snow, the area is relatively moderate throughout the year. The average temperature throughout the year is approximately 16°C. The average temperature is 5~8°C when it is the coldest in January and February and 27~29°C during the heat of summer.



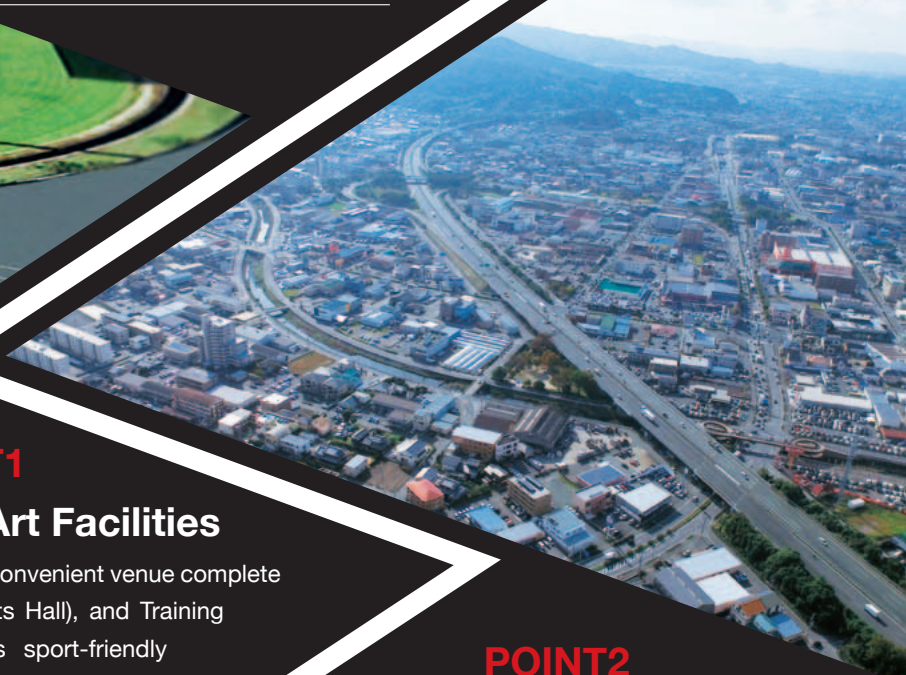

POINT1

State-of-the-Art Facilities

This gymnasium complex is a convenient venue complete with an Arena, Budojyo (Martial Arts Hall), and Training Room. The comfortable and spacious sport-friendly environment, meeting rooms, and medical room make this the ideal training camp venue for the Tokyo Olympics and Paralympics.

POINT2

Excellent Accessibility

The gymnasium is easily accessible and in a convenient location that is only a 45-minute drive from Fukuoka Airport, which is frequently used by many foreigners. The nearby Tosu Junction is a vital junction for traffic and joins Kyushu Expressway to Oita Expressway. The nearest train station, JR Kurume Station, is easily accessible by Shinkansen from all over Japan.

POINT3

Extensive Medical Facilities

The number of doctors per 100,000 residents in Kurume is one of the highest in Japan. Kurume University Hospital is equipped with one of Japan's few advanced emergency medical service centers. There are also numerous research centers and hospitals that provide advanced medical procedures and tests in Kurume. Should there be a medical emergency, Kurume's medical facilities will provide athletes with top-tier care.

POINT4

Rich Culture and Industries

Home to the international Bridgestone Corporation, Kurume City is a pioneer of Japan's rubber industry. The city is also renowned for its diverse variety of traditional crafts, including Kurume Kasuri textiles.

POINT5

Diverse Food Culture and Agriculture

Kurume Ramen, Kurume Yakitori (grilled skewers), and Chikugo Udon (noodles in a light broth) are considered Kurume's "Top Three B-Grade Gourmet", which is inexpensive, local, and delicious cuisine. In addition to Kurume's amazing food culture, visitors will be able to enjoy grape, persimmon, and pear picking.

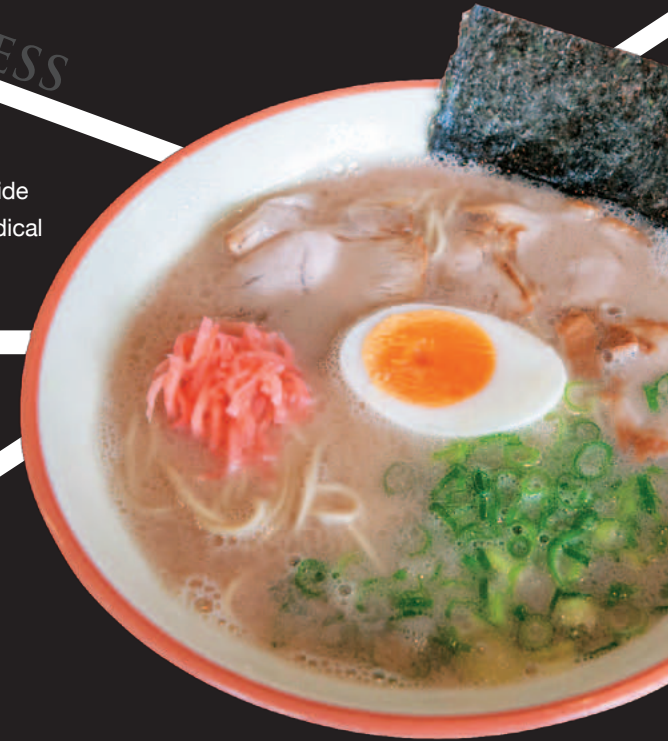

MEDICAL CARE

FACILITY

ACCESS

CULTURE

FOOD

The State-of-the-Art Gymnasium Complex will in Spring 2018 to Create the New, Enriched Kurume Sports Complex.

Over the years, Kurume Sports Complex has hosted numerous athletic competitions with tense, exciting, and dramatic moments. The facility is located in a conveniently accessible city brimming with nature. Chuo Park with beautiful green grass, Hyakunen Park with cherry trees and azalea flowers, and the crystal clear Chikugo River are near Kurume Sports Complex. Extensive discussions were held with athletes in order to create the ideal gymnasium complex. To be completed in spring 2018, the renewed gymnasium complex will transform Kurume Sports Complex into the perfect venue for a diverse range of athletic competitions.



The new state-of-the-art gymnasium is a combination of an Arena, Budojyo (Martial Arts Hall), and Kyudojyo (Japanese Archery Range) that is adjacent to the Track & Field and Baseball Stadium. This venue is the ideal training camp location for a variety of sports.

1F

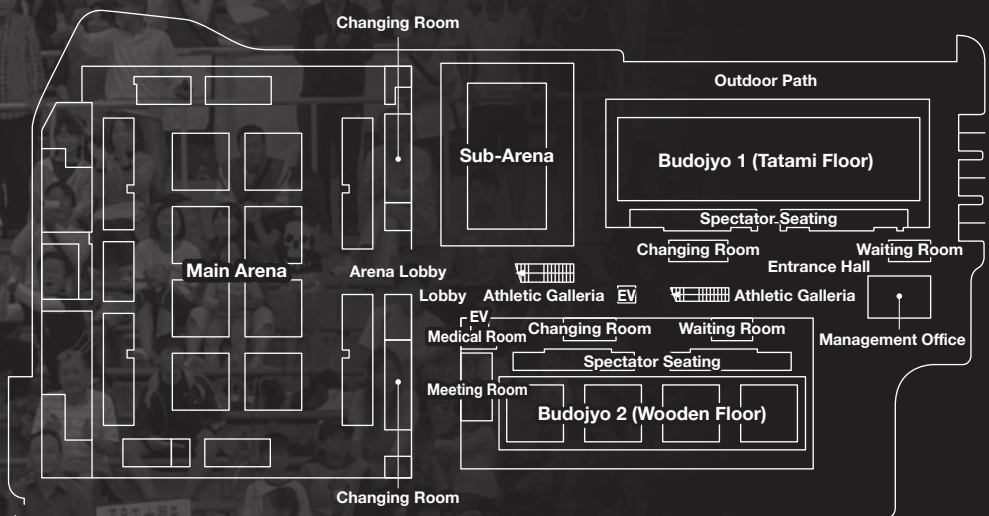

■ Building Area / 14,691.60㎡ ■ Floor Area / 18,815.73㎡ ■ Floors / 2 ■ Building Height / 20.910m

be Completed



Kurume Sports Complex Layout

This sports complex is a combination of an Arena, Sub-Arena, Budojyo (Martial Arts Hall) with a tatami floor and wooden floor, Track & Field, Sub-Track & Field, Baseball Stadium, and a Tennis Court.

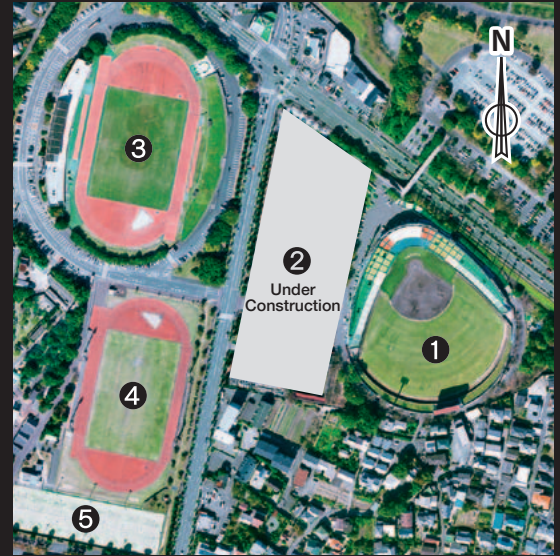

- ① Baseball Stadium
- ② Arena (Gymnasium) / Budojyo (Martial Arts Hall) / Kyudojyo (Japanese Archery Range) / Management Office
- ③ Track & Field
- ④ Sub-Track & Field
- ⑤ Tennis Court
- ※ ② To be completed in 2018

The Main Arena has space for three basketball courts, and the Sub-Arena has one basketball court. There is also space for four Judo mats and four Karate mats in the two Budojyo (Martial Arts Hall), and space for twelve people at the Kyudojyo (Japanese Archery Range). Each of these areas have ample space for people to watch. There is also a large Training Room, Changing Rooms, Meeting Rooms, and a Medical Room. This is a spacious sports complex.

2_F

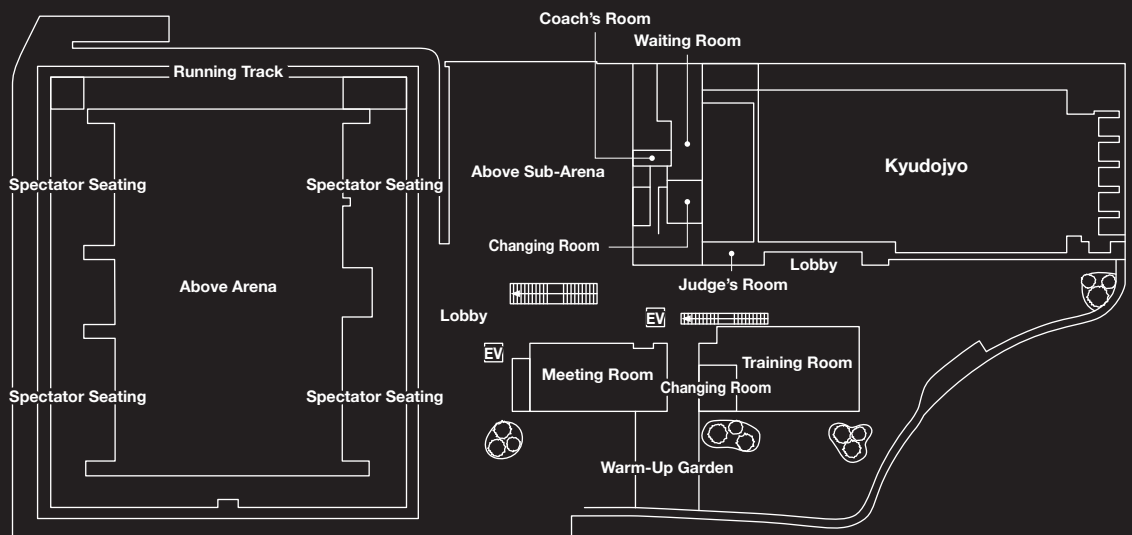

ARENA

One of Japan's Largest Main Arenas, Perfect for Various Competitions

This expansive 40m x 64m space has room for three basketball courts. The 3,000 permanent and 2,000 retractable spectator seats that are in close proximity to the courts provide spectators with an enjoyable experience. The air conditioning system also meets stringent requirements for badminton and table tennis. For Judo and Karate competitions, there is space for eight, official size mats. With state-of-the-art features, this facility is uniquely ideal for various competitive sports.

Flexible Sub-Arena

Adjacent to the Main Arena, the Sub-Arena has space for one basketball court and is the perfect auxiliary space. The very convenient, flexible space can also be transformed into a waiting room for the Budojyo and Kyudojyo.



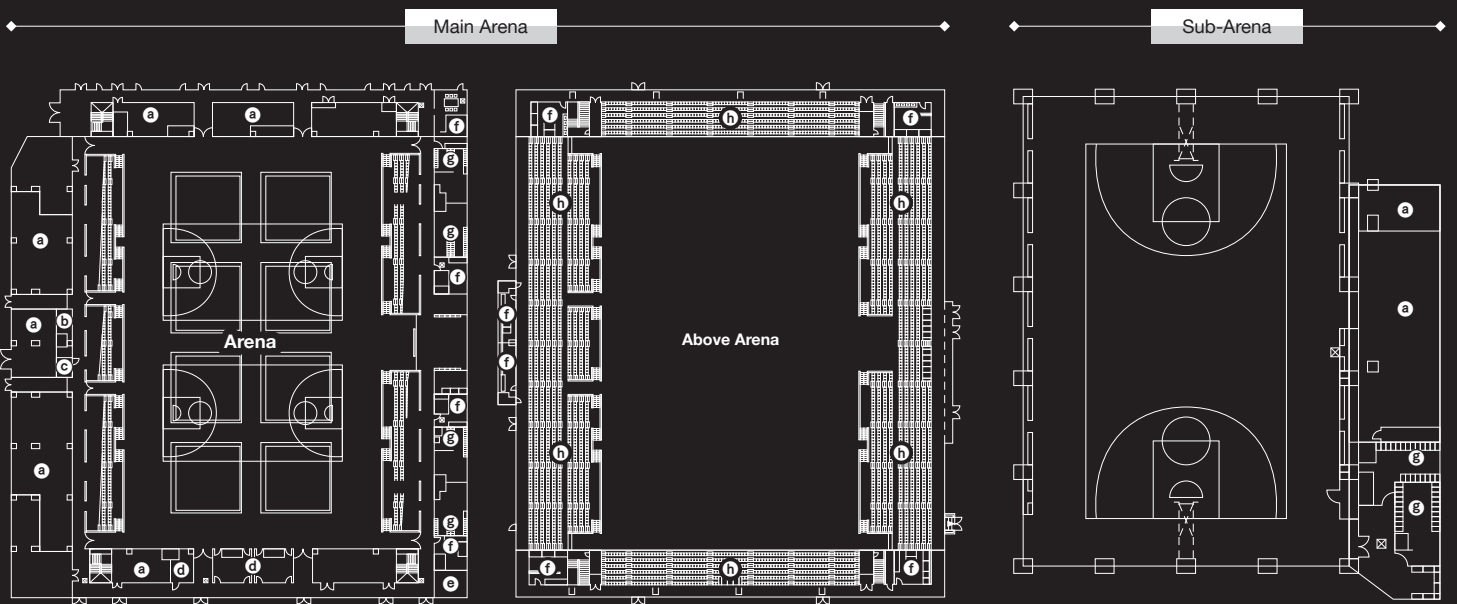

a Equipment Storage **b** Guest Waiting Room **c** Guest Changing Room **d** Athlete Waiting Room **e** Executive Waiting Room **f** Restroom **g** Changing Room **h** Spectator Seating

Arena Floor Space	40m x 64m (2,871 m ²)
Spectator Seating	3,000 Seats (1,731 m ²)
Other Facilities	Guest Waiting Room, Guest Changing Room, Executive Waiting Room, Changing Room 1~4, Athlete Waiting Room 1~3, Equipment Storage 1~11, Audio Equipment Room

Arena Floor Space	23m x 34m (903 m ²)
Other Facilities	Changing Room 1~2, Equipment Storage, Audio Equipment Room

BUDOJYO

■ Budojyo 1 (Tatami Floor)

Space for Twelve Judo Mats Including the Main Arena

This tatami floor Budojyo (Martial Arts Hall) has space for four Judo mats. Combining the space for eight mats in the Main Arena, there is enough space for twelve Judo mats. Along with 280 permanent spectator seats, the Budojyo is complete with executive seating and waiting rooms.



■ Budojyo 2 (Wooden Floor)

280 Permanent Spectator Seats & Versatile Wooden Floor Budojyo

Perfect for exercise and Karate, the wooden floor space can be used for a diverse variety of sports. The adjacent Sub-Arena and tatami floor Budojyo can also be used during training camps.



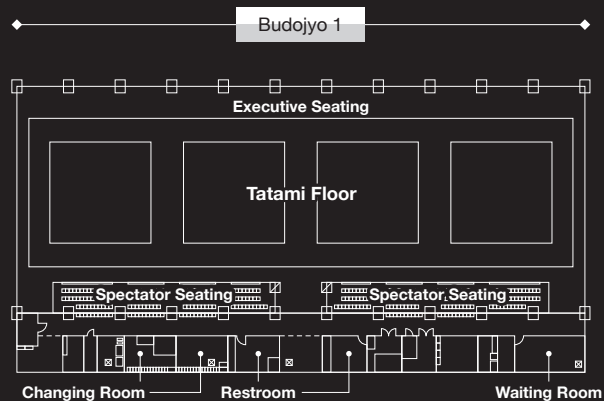

Floor Space	60m×17m	1,109㎡ (4 Judo Mats)
Spectator Seating	286 Seats (Includes 2 Wheelchair Accessible Seats)	167㎡
Other Facilities	Waiting Room, Changing Room 1~2, Equipment Room 1~2	

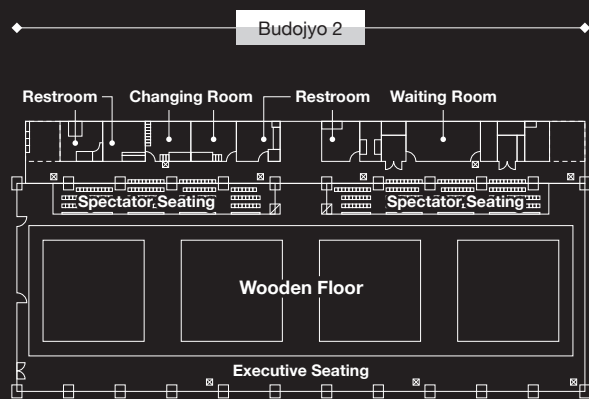

Floor Space	61m×16m	943㎡ (4 Kendo Mats)
Spectator Seating	286 Seats (Includes 2 Wheelchair Accessible Seats)	167㎡
Other Facilities	Waiting Room, Changing Room 1~2, Equipment Room 1~3	



Certified Track & Field Complete with Sub-Track & Field

Officially certified by the Japan Association of Athletics Federations, the Track & Field and the 400m Sub-Track & Field are perfect for training camps.

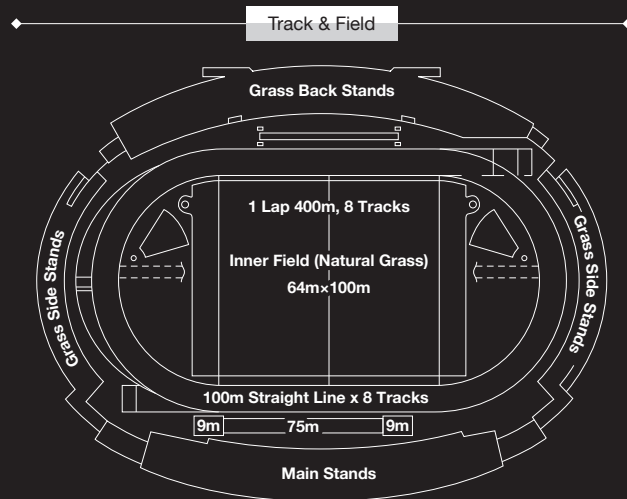

Area	25,050m ² (Building 2,298m ²)
Track	Paved for All-Weather / 400m Lap, 8 Tracks / 100m Straight Line, 8 Tracks
Spectator Capacity (Main Stands)	5,300 People
Spectator Capacity (Back & Side Stands)	12,000 People

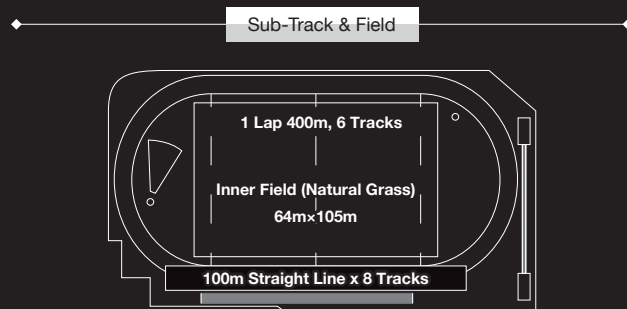

Area	17,885m ²
Track	Paved for All-Weather / 400m Lap, 6 Tracks / 100m Straight Line, 8 Tracks

TRACK & FIELD



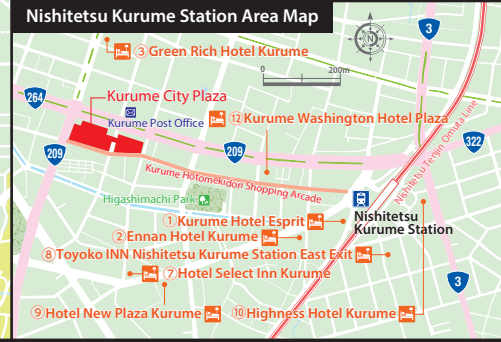
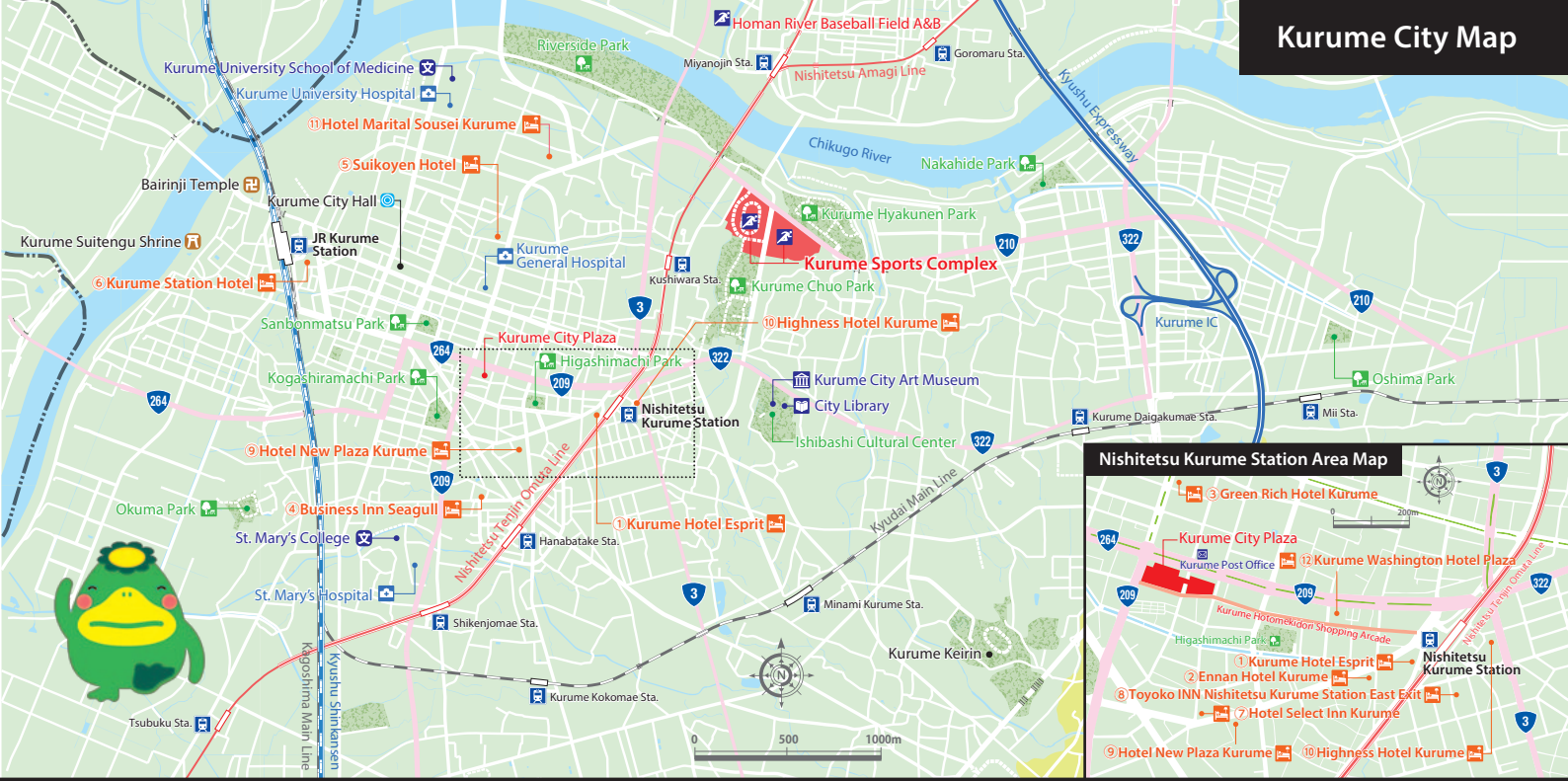

Hotels

- ① Kurume Hotel Esprit
- ② Ennan Hotel Kurume
- ③ Green Rich Hotel Kurume
- ④ Business Inn Seagull
- ⑤ Suikoyen Hotel
- ⑥ Kurume Station Hotel
- ⑦ Hotel Select Inn Kurume
- ⑧ Toyoko INN Nishitetsu Kurume Station East Exit
- ⑨ Hotel New Plaza Kurume
- ⑩ Highness Hotel Kurume
- ⑪ Hotel Marital Sousei Kurume
- ⑫ Kurume Washington Hotel Plaza

Legend

- Kyushu Shinkansen
- JR Train Line
- Nishi-Nippon Railroad
- Kyushu Expressway
- National Route
- Hotel
- Hospital
- Park
- Temple
- Shrine
- School
- Athletic Grounds
- Library
- Museum

Access to Kurume

Only two hours from Tokyo, flying on one of the 66 daily flights to and from Fukuoka Airport makes accessing Fukuoka from cities all over the world extremely convenient. There are also many direct flights to Fukuoka or transiting through Incheon from major East Asian and ASEAN cities. After arriving at Fukuoka Airport, Kurume is easily accessible via Shinkansen (bullet train) or highway bus.

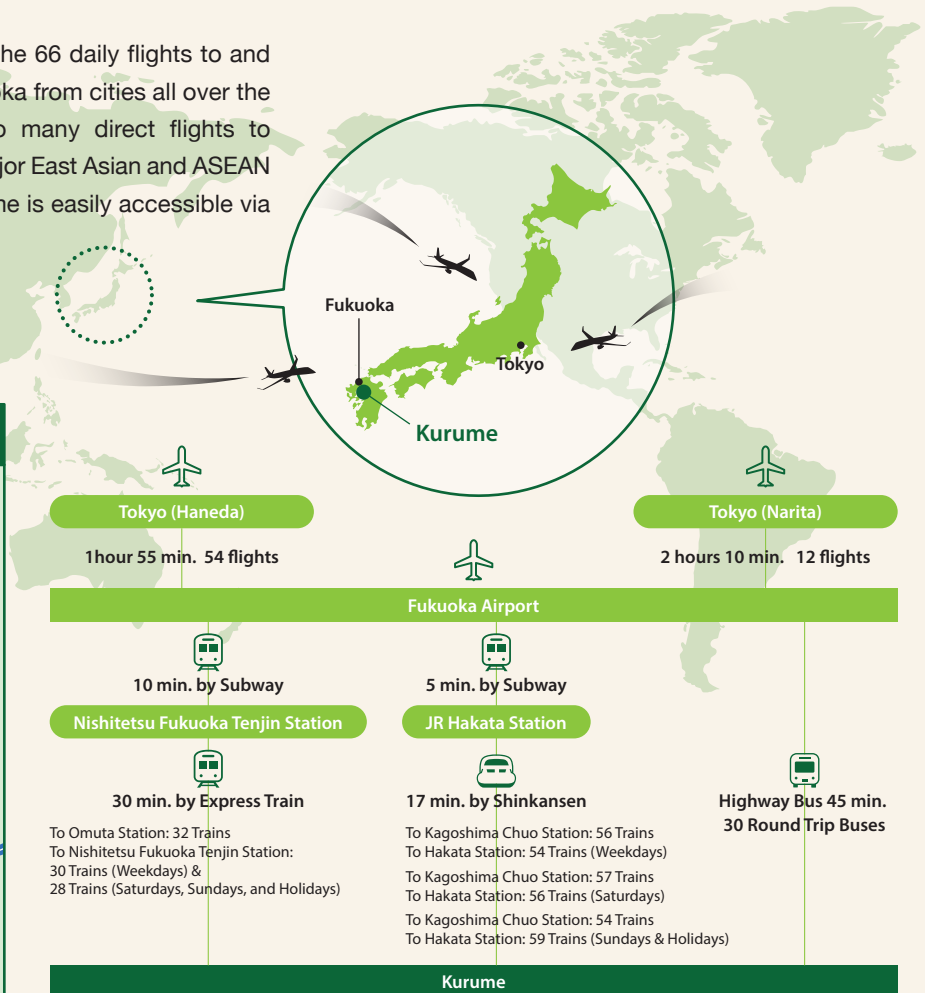
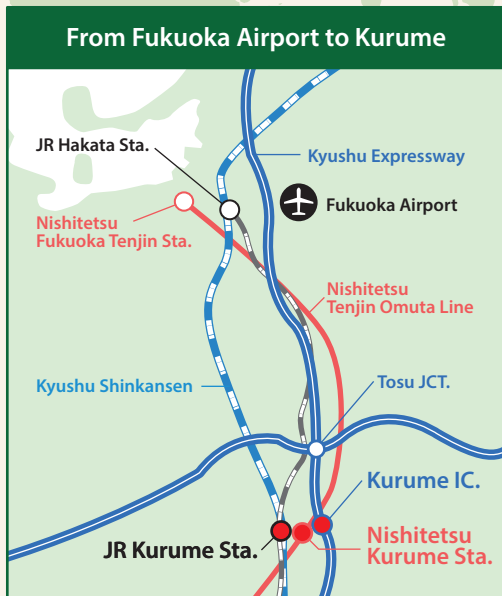



JAPAN

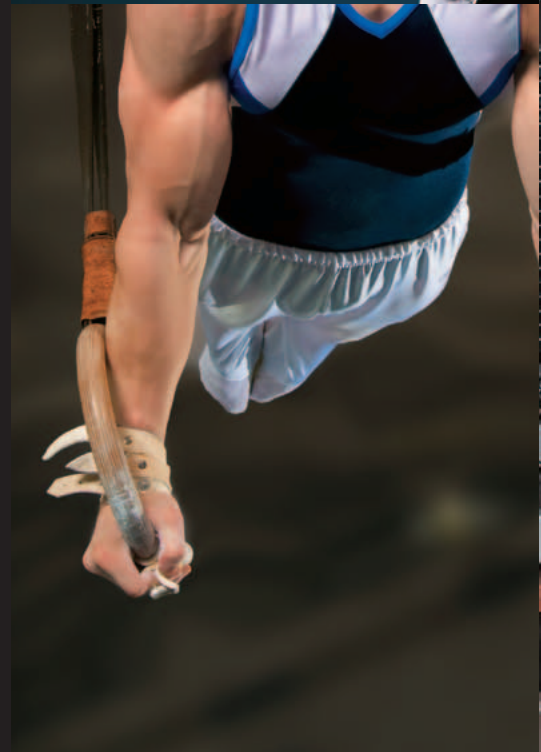

Kurume City, Resident's Culture Division, Physical Education & Sports Section

Shojima Gymnasium, 11-1 Shojimamachi, Kurume,
Fukuoka Prefecture, Japan, 830-0042

TEL:+81-942-30-9226 FAX:+81-942-38-2259

URL:<http://www.city.kurume.fukuoka.jp>